

MADE TO LAST FOR YEARS

# Shinhoo



## Household pumps

**Anhui Shinhoo Canned Motor Pump Co., Ltd.**

Address: No.780, Ming Chuan Road, High-Tech Zone,  
Hefei, Anhui, P.R China

Tel.: +86-551-62379800

E-mail: info@shinhoodump.com

For information only. Technical modifications are possible.  
All rights reserved.

Product Manual

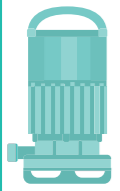

# CONTENTS

01 Household Pumps

02 Permanent magnet centrifugal pump

03 Swimming pool pumps



MADE TO LAST FOR YEARS

## Household Pumps

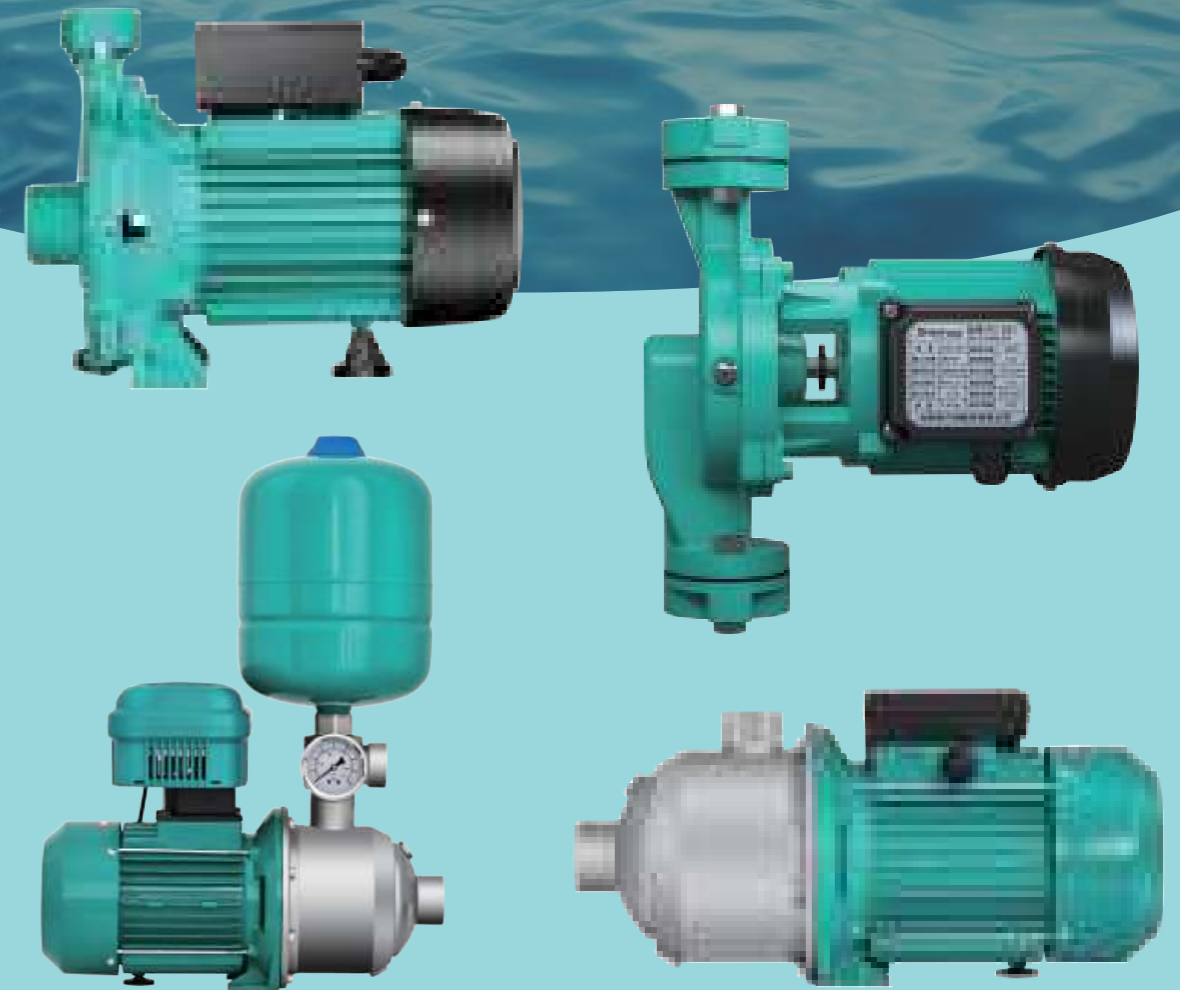

### Application:

1. Hot water circulation and heating system
2. Air/Ground source heat pump system
3. Industrial circulation system
4. Solar energy system
5. Cleaning and garden irrigation system
6. HVAC circulation system
7. Home and commercial water supply system
8. Boiler water supply system
9. Cooling water system

# Structural Diagram

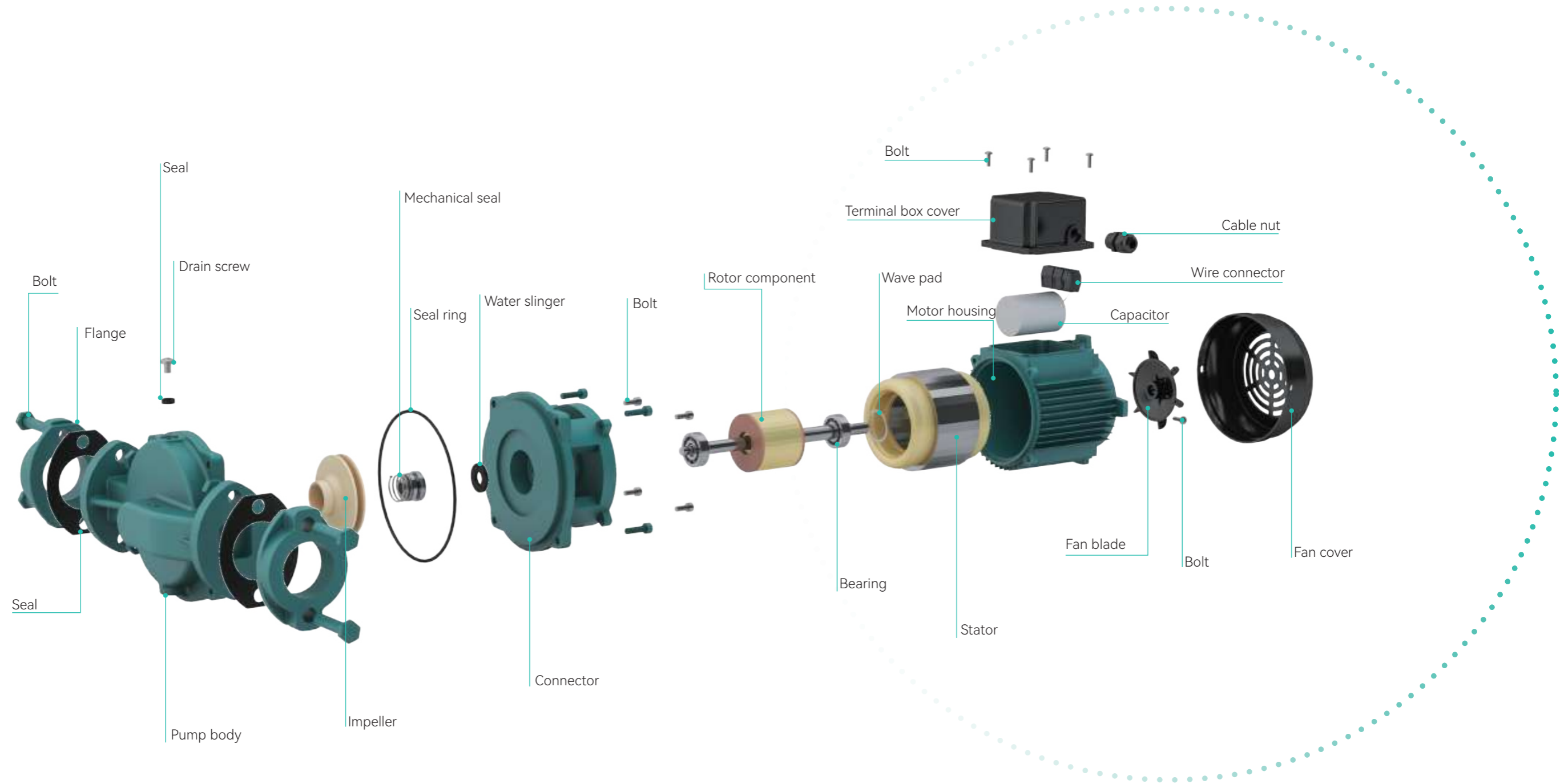



# AP Series

## HOT WATER CIRCULATING PUMP

### Product advantages

1. Pipe installation, easy connection
2. Compact structure, space saving
3. Low noise, long service life
4. High quality mechanical seal, reliable and easy maintenance
5. Painted appearance, simple and elegant

### Technical parameter

|                     |   |
|---------------------|---|
| Power supply        | 1~220V/50Hz , 3~380V/50Hz   |
| Motor protection    | Single-phase motor with thermal protection, three-phase motor without |
| IP protection       | IP22 , IP44 , IP55  |
| Insulation          | F   |
| (RH) Humidity       | ≤95%  |
| System pressure     | 0.2Mpa , 0.3Mpa , 0.5Mpa  |
| Certificate         | CE  |
| Ambient temperature | 0~40°C  |
| Liquid temperature  | 0~90°C (clean water)  |

# Performance Curve

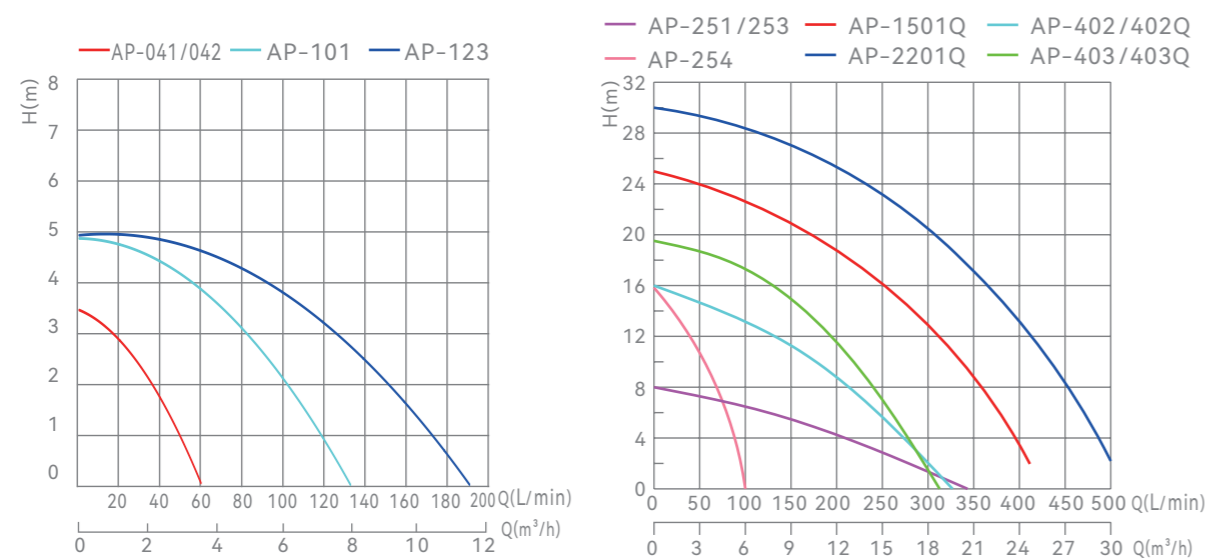

## Installation dimensions

Model:AP-041/042

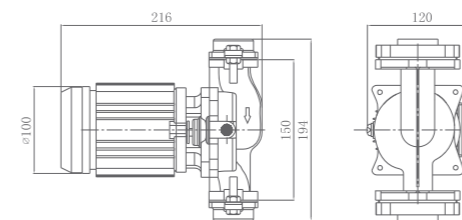

Model:AP-101

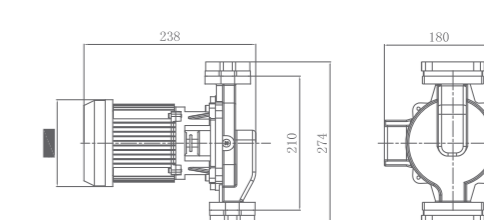

Model:AP-254

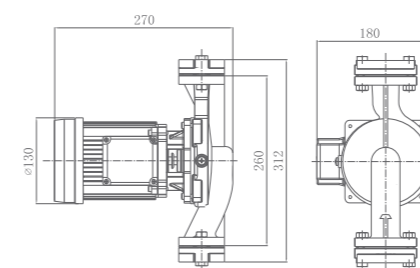

Model:AP-1501Q/2201Q

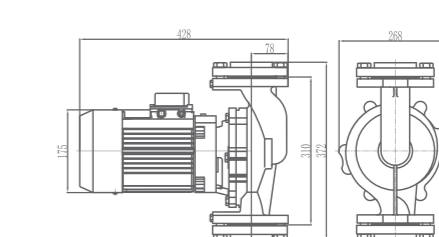

Model:AP-123/251/253

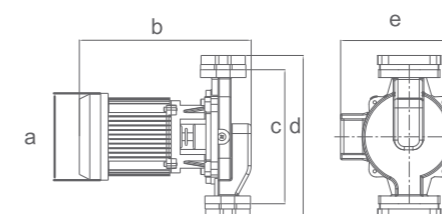

Model:AP-402/402Q/403/403Q

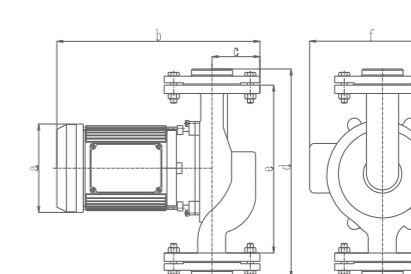

| MODEL   | a    | b   | c   | d   | e   | f   |
|---------|------|-----|-----|-----|-----|-----|
| AP-123  | φ130 | 275 | 260 | 312 | 180 | /   |
| AP-251  | φ148 | 290 | 290 | 345 | 190 | /   |
| AP-253  | φ148 | 290 | 290 | 345 | 190 | /   |
| AP-402  | φ148 | 335 | 80  | 335 | 280 | 224 |
| AP-403  | φ148 | 335 | 80  | 335 | 280 | 224 |
| AP-403Q | φ148 | 365 | 80  | 335 | 280 | 224 |

# Related Products

AP-041/042

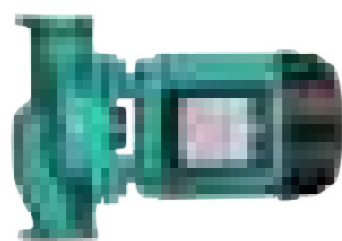

AP-101



AP-123/251/253



AP-254



AP-402/403/403Q

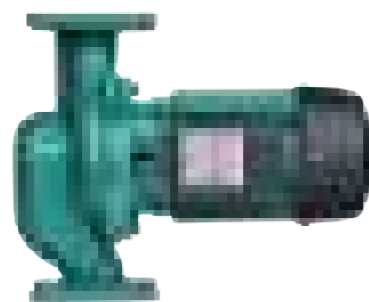

AP-1501Q/2201 Q



## Product parameter

| Model                  | AP-041  | AP-042 | AP-101 | AP-123 | AP-251 | AP-253 | AP-254 | AP-402 | AP-403      | AP-403Q   | AP-1501Q | AP-2201Q |
|------------------------|---|--------|--------|--------|--------|--------|--------|--------|-------------|-----------|----------|----------|
| Electrical connection  |   |        |        |        |        |        |        |        |             |           |          |          |
| Power supply           | 1-220V/50Hz                                     |        |        |        |        |        |        |        | 3-380V/50Hz |           |          |          |
| Input power (W)        | 90  | 90     | 200    | 220    | 410    | 400    | 330    | 850    | 1000        | 1000      | 1750     | 2800     |
| Output power (W)       | 40  | 40     | 100    | 125    | 250    | 250    | 250    | 750    | 750         | 750       | 1500     | 2200     |
| Application            |   |        |        |        |        |        |        |        |             |           |          |          |
| Transmission medium    | Clean water                                     |        |        |        |        |        |        |        |             |           |          |          |
| Medium temperature(°C) | 0-90  |        |        |        |        |        |        |        |             |           |          |          |
| Maximum head (m)       | 3.5   | 3.5    | 5      | 5      | 7.5    | 7.5    | 15     | 16     | 20          | 20        | 25       | 30       |
| Maximum flow(L/min)    | 60  | 60     | 130    | 190    | 230    | 230    | 100    | 310    | 300         | 300       | 417      | 467      |
| Rated flow (L/min)     | 28  | 28     | 85     | 135    | 190    | 190    | 50     | 180    | 130         | 130       | 266      | 308      |
| Rated head (m)         | 2.5   | 2.5    | 3      | 3      | 4      | 4      | 10     | 10     | 16          | 16        | 15       | 20       |
| Inlet size (mm)        | 25  | 32     | 40     | 50     | 65     | 50     | 40     | 80     | 50          | 50        | 50       | 50       |
| Outlet size (mm)       | 25  | 32     | 40     | 50     | 65     | 50     | 40     | 80     | 50          | 50        | 50       | 50       |
| Maximum pressure (bar) | 2.0   | 2.0    | 2.0    | 2.0    | 2.0    | 2.0    | 3.0    | 5.0    | 5.0         | 5.0       | 5.0      | 5.0      |
| Protection level       | IP22  | IP22   | IP22   | IP22   | IP22   | IP22   | IP44   | IP44   | IP44        | IP55      | IP55     | IP55     |
| Weight (kg)            | 3.5   | 3.5    | 7.6    | 9.6    | 14     | 14     | 9      | 17.5   | 19          | 19        | 33       | 35       |
| Material               |   |        |        |        |        |        |        |        |             |           |          |          |
| Pump body              | Cast iron                                       |        |        |        |        |        |        |        |             |           |          |          |
| Impeller               | Engineering plastic                             |        |        |        |        |        | Brass  |        |             | Cast iron |          |          |
| Shaft                  | Stainless steel                                 |        |        |        |        |        |        |        |             |           |          |          |
| Mechanical seal        | Graphite & ceramic / graphite & silicon carbide |        |        |        |        |        |        |        |             |           |          |          |

# Structural Diagram

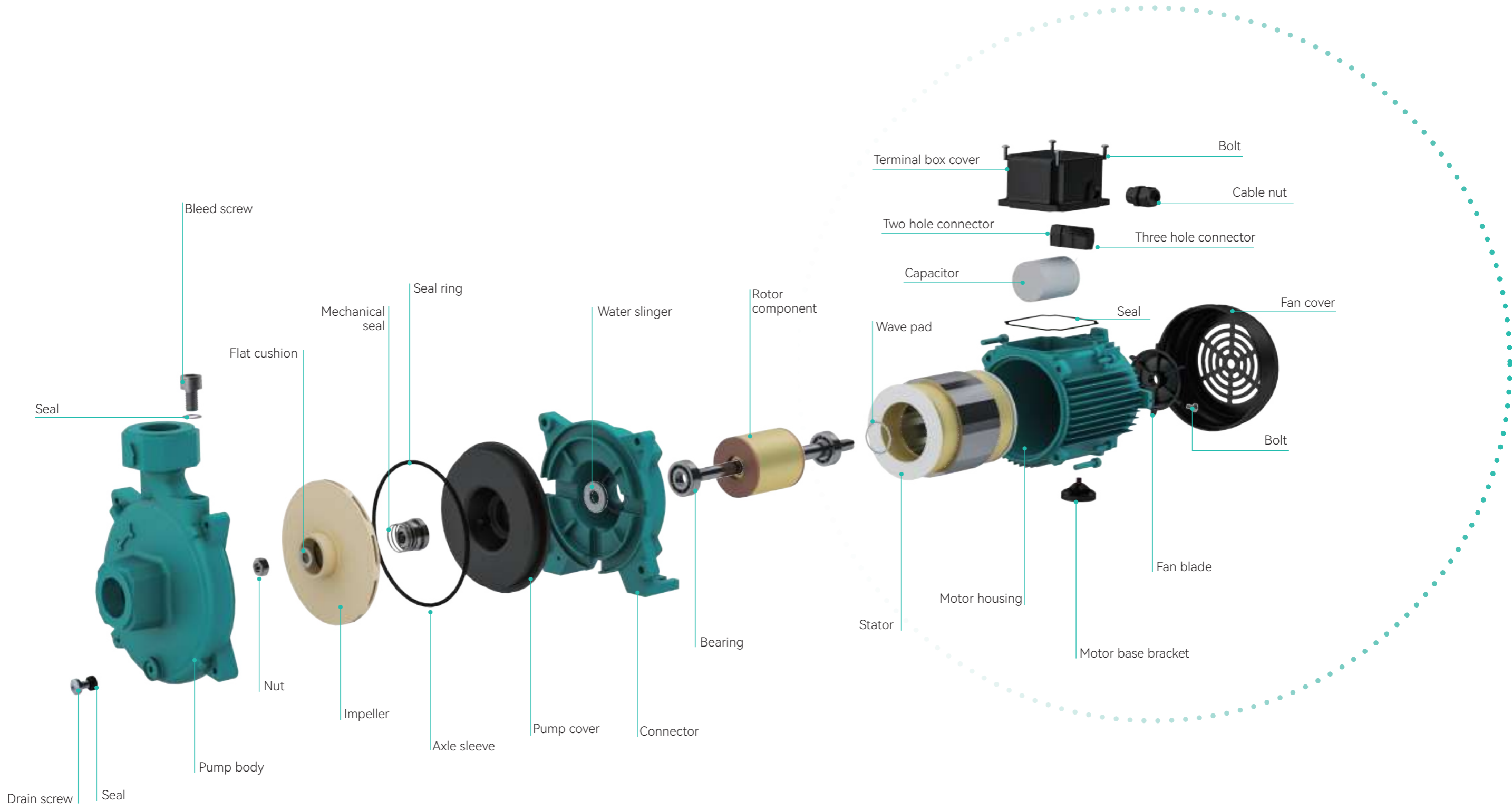



## Product advantages

1. The pump body is coated with a special coating, Rust resistance
2. Low noise and high head
3. Compact structure and light appearance
4. High quality mechanical seal, reliable and easy to maintain
5. Painted appearance, simple and elegant

## Technical parameter

|                     |   |
|---------------------|---|
| Power supply        | 1~220V/50Hz , 3~380V/50Hz   |
| Motor protection    | Single-phase motor with thermal protection, three-phase motor without |
| IP protection       | IP44  |
| Insulation          | F   |
| (RH) Humidity       | ≤95%  |
| System pressure     | 0.4Mpa.0.5Mpa   |
| Certificate         | CE  |
| Ambient temperature | 0~40°C  |
| Liquid temperature  | 0~90°C (clean water)  |



# AHB Series

## Household Pump

# Performance Curve

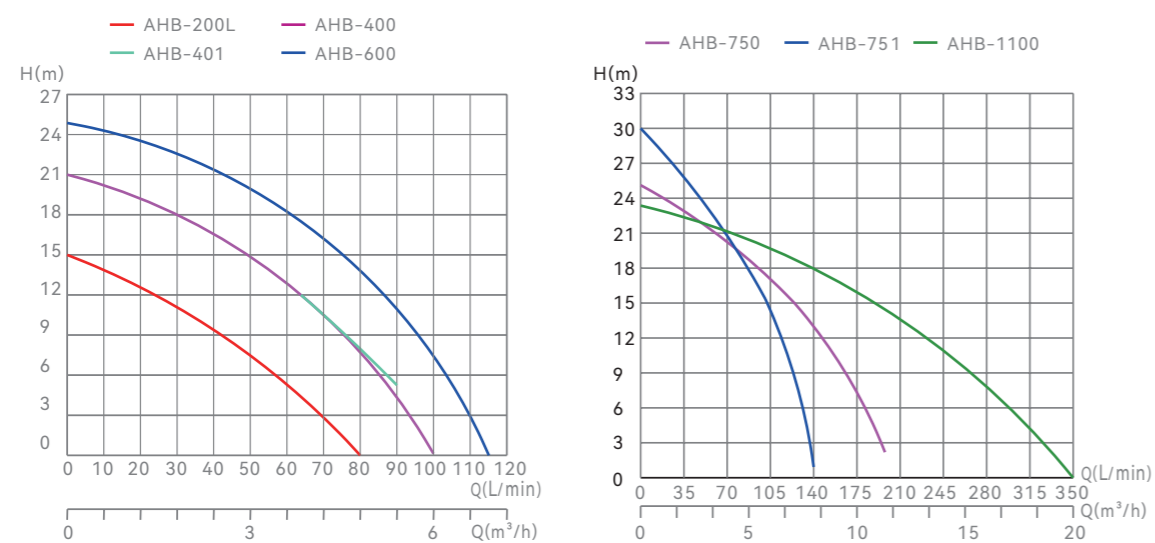

## Installation dimensions

Model: AHB-200L

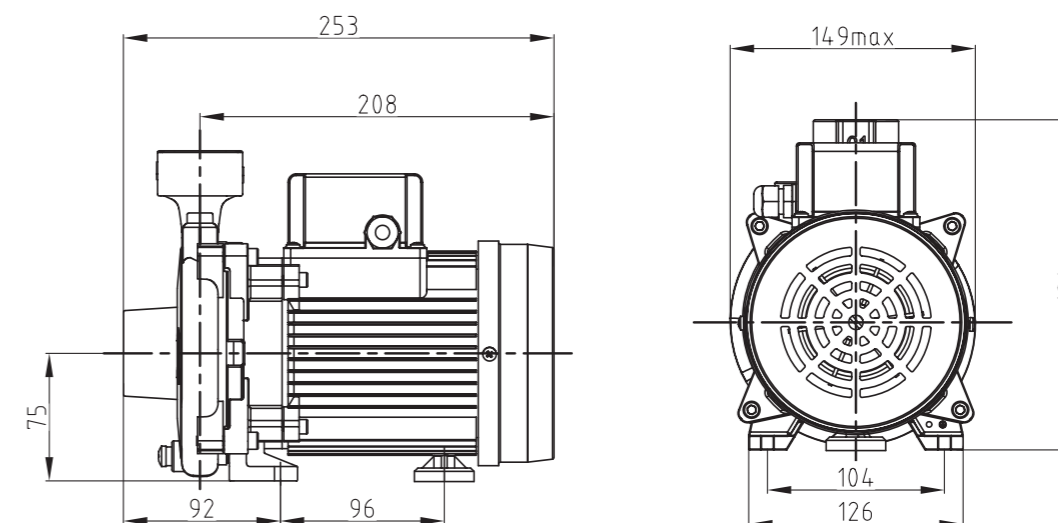

Model: AHB-400/600/750/751

Model: AHB-1100

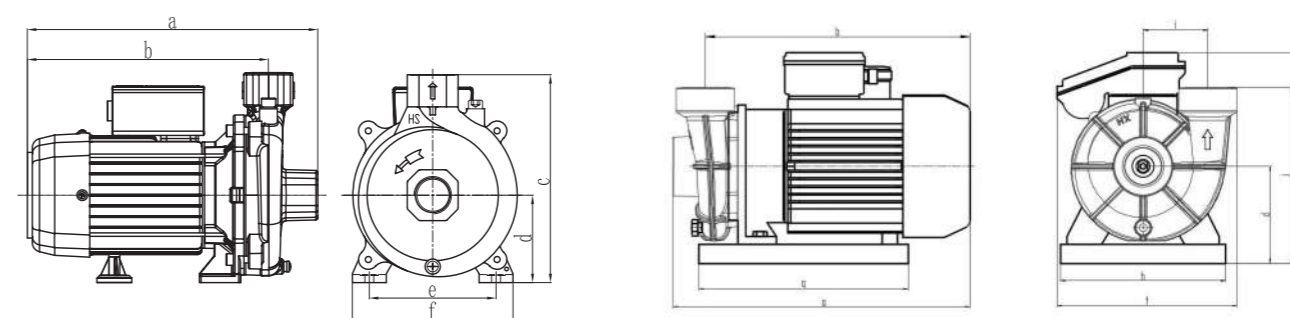

| MODEL    | a     | b   | c   | d   | e   | f   | g     | h   | i   |
|----------|-------|-----|-----|-----|-----|-----|-------|-----|-----|
| AHB-400  | 283   | 243 | 219 | 94  | 124 | 172 | 172   | 172 | 172 |
| AHB-600  | 306   | 258 | 230 | 98  | 142 | 180 | 180   | 180 | 180 |
| AHB-750  | 322   | 269 | 233 | 98  | 142 | 180 | 180   | 180 | 180 |
| AHB-751  | 315   | 269 | 234 | 98  | 142 | 180 | 180   | 180 | 180 |
| AHB-1100 | 384.5 | 345 | 275 | 126 | /   | 240 | 294.5 | 219 | 85  |

# Related Products



AHB-200L



AHB-600

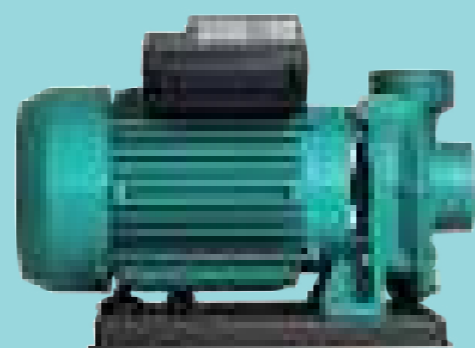

AHB-1100

## Product parameter

| Model                  | AHB-200L    | AHB-400 | AHB-401                 | AHB-600 | AHB-750     | AHB-751 | AHB-1100 |
|------------------------|-------------|---------|-------------------------|---------|-------------|---------|----------|
| Electrical connection  |             |         |                         |         |             |         |          |
| Power supply           | 1-220V/50Hz |         | 1-220V 50Hz 3-380V/50Hz |         | 1-220V/50Hz |         |          |
| Input power (W)        | 320         | 680     | 660                     | 880     | 1100        | 1250    | 1500     |
| Output power (W)       | 200         | 400     | 400                     | 600     | 750         | 750     | 1100     |
| Application            |             |         |                         |         |             |         |          |
| Transmission medium    | Clean water |         |                         |         |             |         |          |
| Medium temperature(°C) | 0~90        |         |                         |         |             |         |          |
| Performance parameter  |             |         |                         |         |             |         |          |
| Maximum head (m)       | 15          | 21      | 21                      | 25      | 25          | 30      | 23       |
| Maximum flow (L/min)   | 80          | 100     | 90                      | 115     | 200         | 125     | 360      |
| Rated flow (L/min)     | 38          | 50      | 50                      | 50      | 110         | 80      | 220      |
| Rated head (m)         | 10          | 15      | 15                      | 20      | 17.5        | 20      | 15       |
| Inlet size (mm)        | 25          | 32      | 25                      | 25      | 32          | 32      | 50       |
| Outlet size (mm)       | 25          | 32      | 25                      | 25      | 32          | 32      | 50       |
| Maximum pressure (bar) | 5.0         | 5.0     | 5.0                     | 5.0     | 4.0         | 4.0     | 4.0      |
| Protection level       | IP44        | IP44    | IP44                    | IP44    | IP44        | IP44    | IP44     |
| Weight (kg)            | 7.2         | 11      | 11                      | 12      | 13          | 13      | 21       |

# Structural Diagram

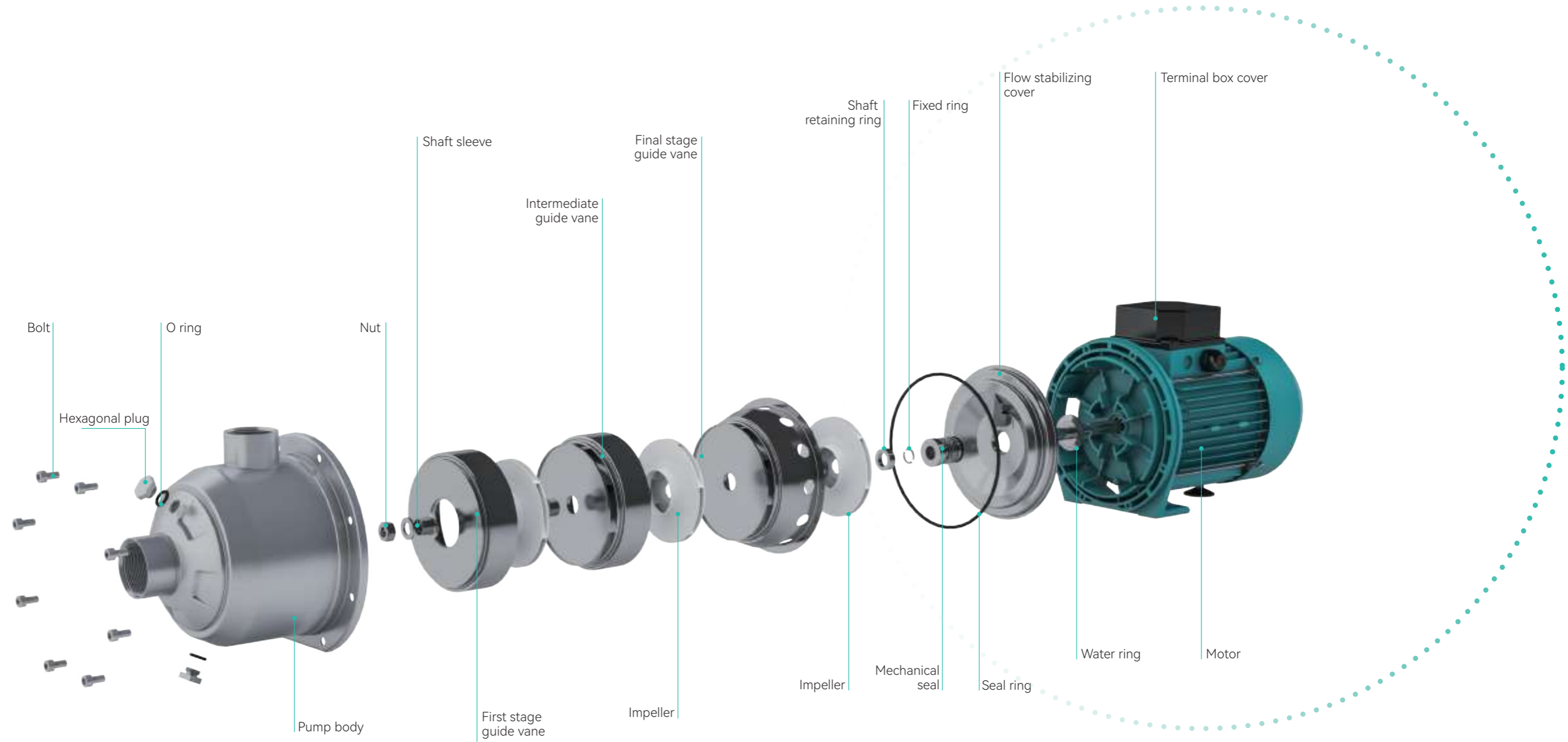



# AHM Series

## Horizontal multi-stage centrifugal water pump

### Product advantages

1. Water-passing parts are made of stainless steel
2. Multi-stage impeller, high head
3. High quality mechanical seal, reliable and easy to maintain
4. NSK bearings, long life, low noise
5. Painted appearance, simple and elegant

### Technical parameter

|                     |  |
|---------------------|--|
| Power supply        | 1~220V/50Hz , 3~380V/50Hz  |
| Power supply        | Single-phase motor with thermal protection, three-phase motor without    |
| IP protection       | IP54   |
| Insulation          | F  |
| (RH) Humidity       | ≤95%   |
| System pressure     | 1MPa   |
| Certificate         | CE   |
| Ambient temperature | 0~40°C   |
| Liquid temperature  | 0~90°C (clean water) , -15~110°C (Water+ethylene glycol (≤ 50%) mixture) |

# Performance Curve

Model:AHM 202/203

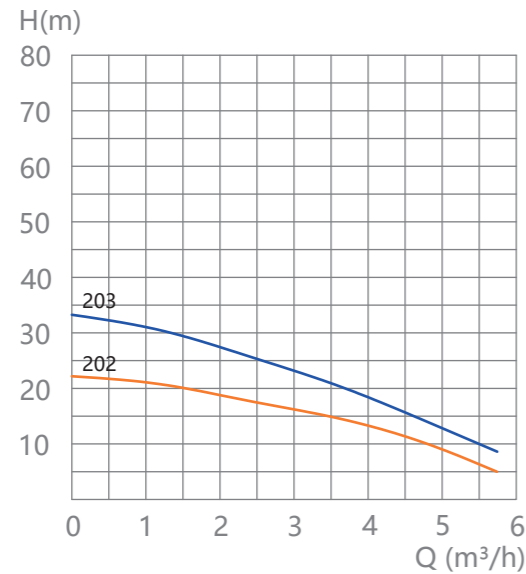

Model:AHM 403/404/405

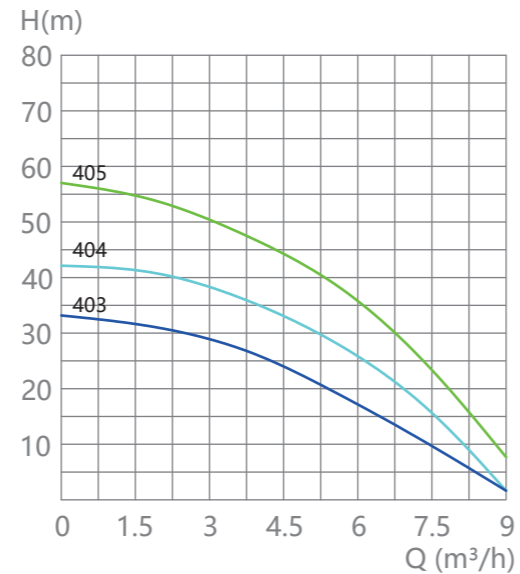

Model:AHM 803/804/805T

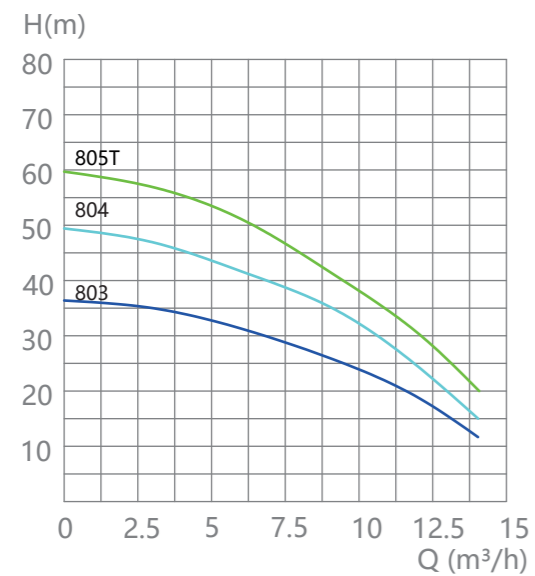

Model:AHM 1603T/1604T

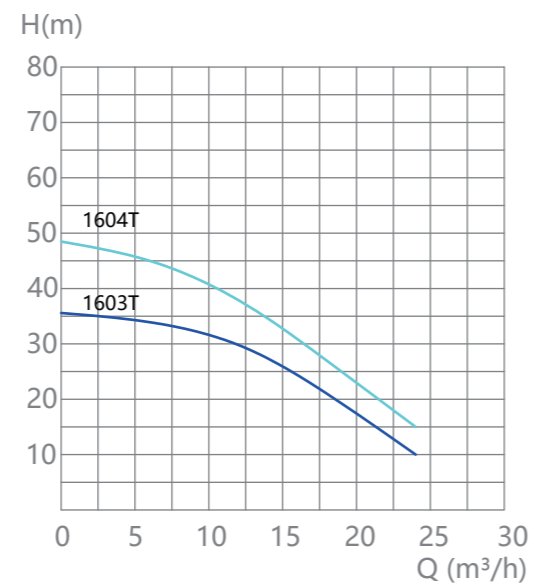

## Installation dimensions

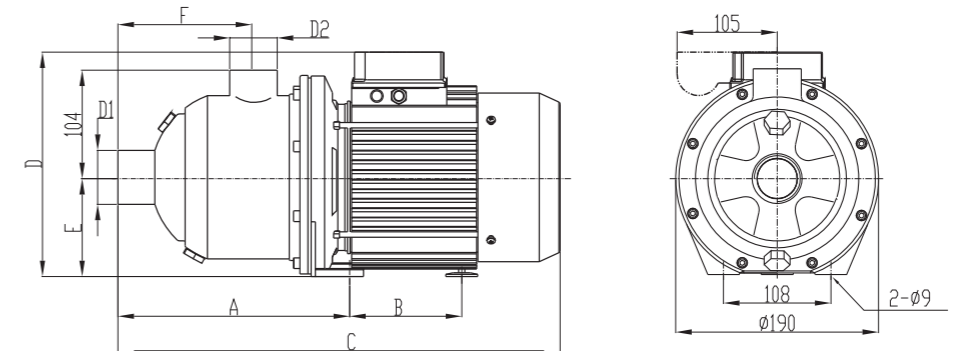

## Product parameter

| Model    | Rated power (kw) | Rated current(A) |        |        | ΦD1 | ΦD2 | A   | B      |        | C      |        | D      |        | E   |     | F   |      |
|----------|------------------|------------------|--------|--------|-----|-----|-----|--------|--------|--------|--------|--------|--------|-----|-----|-----|------|
|          |                  | 1-220V           | 3-220V | 3-380V |     |     |     | 1-220V | 3-380V | 1-220V | 3-380V | 1-220V | 3-380V |     |     |     |      |
|          |                  | [mm]             |        |        |     |     |     |        |        |        |        |        |        |     |     |     |      |
| AHM202   | 0.37             | 2.58             | 1.89   | 1.09   | 1"  | 1"  | 205 | 85     | 85     | 375    | 375    | 205    | 198    | 90  | 90  | 107 | 9    |
| AHM203   | 0.55             | 3.46             | 2.56   | 1.48   | 1"  | 1"  | 205 | 85     | 85     | 375    | 375    | 205    | 198    | 90  | 90  | 107 | 9    |
| AHM403   | 0.55             | 3.46             | 2.56   | 1.48   | 1½" | 1"  | 201 | 85     | 85     | 371    | 371    | 205    | 198    | 90  | 90  | 104 | 10.4 |
| AHM404   | 0.75             | 4.85             | 3.01   | 1.74   | 1½" | 1"  | 250 | 100    | 100    | 448    | 448    | 210    | 198    | 90  | 90  | 153 | 13.6 |
| AHM405   | 1.10             | 6.55             | 4.40   | 2.54   | 1½" | 1"  | 250 | 100    | 100    | 448    | 448    | 210    | 213    | 90  | 90  | 153 | 15.4 |
| AHM803   | 1.10             | 6.55             | 4.40   | 2.54   | 1½" | 1½" | 212 | 100    | 100    | 410    | 410    | 210    | 213    | 90  | 90  | 115 | 14.5 |
| AHM804   | 1.50             | 9.15             | 6.10   | 3.52   | 1½" | 1½" | 272 | 145    | 145    | 500.5  | 500.5  | 227    | 230    | 100 | 100 | 175 | 18.3 |
| AHM805T  | 1.85             | —                | 6.95   | 4.01   | 1½" | 1½" | 272 | —      | 145    | —      | 500.5  | —      | 230    | —   | 100 | 175 | —    |
| AHM1603T | 1.85             | —                | 6.95   | 4.01   | 2"  | 1½" | 233 | —      | 145    | —      | 461.5  | —      | 230    | —   | 100 | 136 | —    |
| AHM1604T | 2.20             | —                | 9.70   | 5.60   | 2"  | 1½" | 278 | —      | 145    | —      | 506.5  | —      | 230    | —   | 100 | 181 | —    |

| Model                  | AHM200   | AHM400 | AHM800 | AHM1600          |
|------------------------|--|--------|--------|------------------|
| Power supply           | 1-220V/50Hz 3-380(220)V/50Hz   |        |        | 3-380(220)V/50Hz |
| Application            | Clean water  |        |        |                  |
| Transmission medium    | Clean water  |        |        |                  |
| Medium temperature(°C) | 0~90°C (Clean water) , -15~110°C (Water + ethylene glycol (≤50%) mixed liquid) |        |        |                  |
| Performance parameter  |  |        |        |                  |
| Maximum head (m)       | 33   | 57     | 59     | 48               |
| Maximum flow(m³/h)     | 5  | 8      | 12     | 26               |
| Maximum pressure (bar) | 10   |        |        |                  |
| Protection level       | IP54   |        |        |                  |
| Material               |  |        |        |                  |
| Pump body              | Stainless steel  |        |        |                  |
| Impeller               | Stainless steel  |        |        |                  |
| Shaft                  | Stainless steel  |        |        |                  |
| Mechanical seal        | Graphite & silicon carbide   |        |        |                  |

# Structural Diagram



## Product advantages

1. Constant pressure water supply
2. Automatic energy-saving operation
3. Multiple protection functions
4. Automatic stand-by
5. Automatic start function when power is on

## Technical parameter

|                      |  |
|----------------------|--|
| Power supply voltage | 1~220V/50Hz , 3~380V/50Hz  |
| Motor protection     | Single-phase motor with thermal protection, three-phase motor without    |
| IP protection        | IP42   |
| Insulation           | F  |
| (RH) Humidity        | ≤95%   |
| System pressure      | 0.7Mpa   |
| Certificate          | CE for pump  |
| Ambient temperature  | 0~40°C   |
| Liquid temperature   | 0~90°C (Clean water) , -15~110°C (Water+ethylene glycol (≤ 50%) mixture) |



# F-AHM Series

Horizontal multi-stage variable  
frequency pump

# Performance Curve

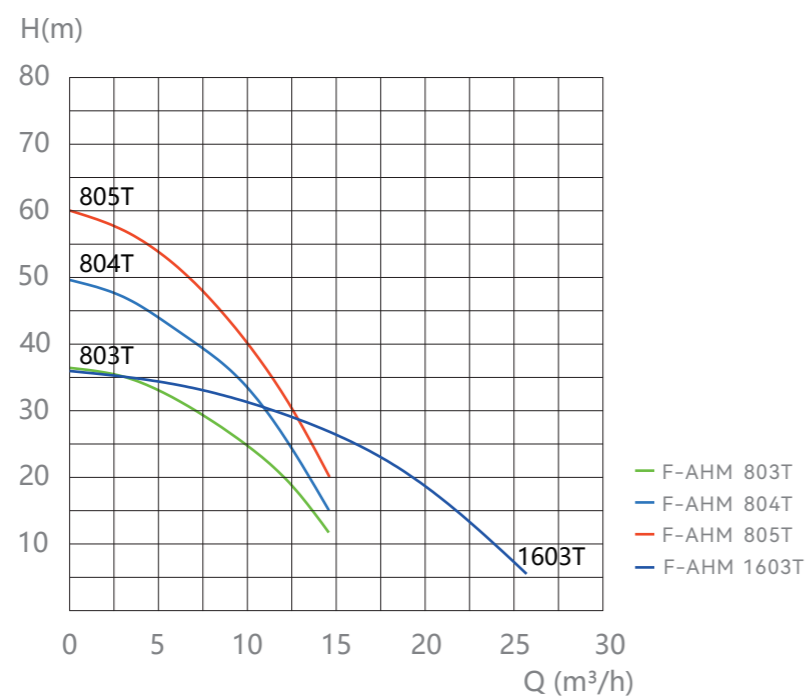
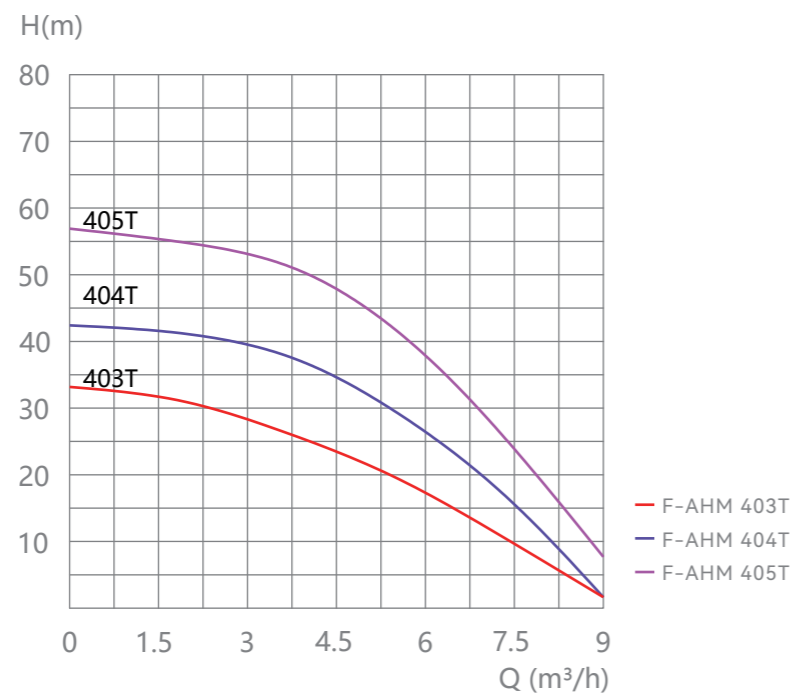

## Installation dimensions

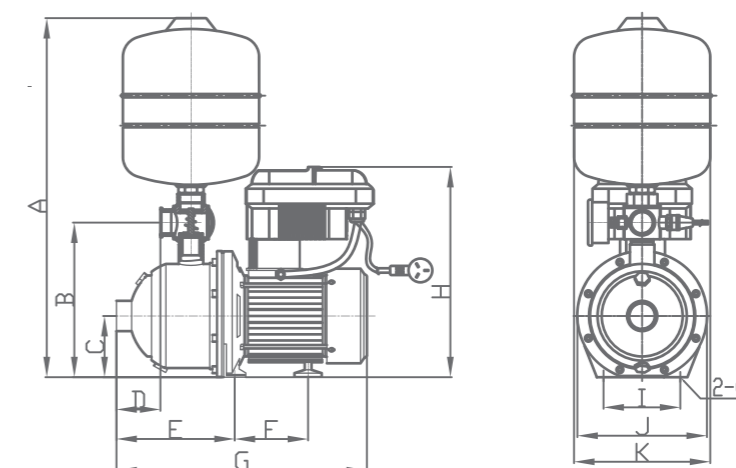

| Model      | Rated power (kW) | A   | B     | C  | D    | E   | F   | G     | H   | I   | J    | K   |
|------------|------------------|-----|-------|----|------|-----|-----|-------|-----|-----|------|-----|
| F-AHM403T  | 0.55             | 525 | 225   | 90 | 64.5 | 201 | 85  | 371   | 308 | 108 | φ190 | 200 |
| F-AHM404T  | 0.75             | 525 | 225   | 90 | 101  | 250 | 100 | 448   | 308 | 108 | φ190 | 200 |
| F-AHM405T  | 1.1              | 565 | 225   | 90 | 101  | 250 | 100 | 448   | 316 | 108 | φ190 | 200 |
| F-AHM803T  | 1.1              | 570 | 226.5 | 90 | 76.5 | 212 | 100 | 410   | 316 | 108 | φ190 | 200 |
| F-AHM804T  | 1.5              | 570 | 228   | 90 | 137  | 272 | 145 | 500.5 | 331 | 108 | φ190 | 200 |
| F-AHM805T  | 1.85             | 570 | 228   | 90 | 137  | 272 | 145 | 500.5 | 331 | 108 | φ190 | 200 |
| F-AHM1603T | 1.85             | 570 | 228   | 90 | 89.5 | 233 | 145 | 461.5 | 331 | 108 | φ190 | 200 |

## Product parameter

|                        | F-AHM 400Q  | F-AHM 800Q | F-AHM 1600Q  |
|------------------------|---|------------|--|
| Power supply           | Input single-phase 220v/50Hz,output single-phase 220v/50Hz              |            | Input three-phase 380v/50Hz,output three-phase 220v/50Hz |
| Application            | Clean water   |            |  |
| Transmission medium    | Clean water   |            |  |
| Medium temperature(°C) | 0~90°C (Clean water) .-15~110°C (Water+ethylene glycol (≤ 50%) mixture) |            |  |
| Performance parameter  |   |            |  |
| Maximum head (m)       | 57  | 59         | 36   |
| Maximum flow(m³/h)     | 8   | 12         | 26   |
| Inlet size             | 1 ¼"  | 1 ½"       | 2"   |
| Outlet size            | 1"  | 1 ¼"       | 1 ½"   |
| Protection level       | IP42  |            |  |
| Maximum pressure (bar) | 7   |            |  |

MADE TO LAST FOR YEARS



### Application:

1. Commercial water boosting
2. Domestic groundwater extraction
3. Domestic water supply boosting

Permanent magnet  
centrifugal pump



## Application

- Commercial water boosting
- Domestic groundwater extraction
- Domestic water supply boosting



## Operation Condition

| Model                     | PFM03-30EC Pro | PFM03-30EC | PFB06-22EC   |
|---------------------------|----------------|------------|--------------|
| Voltage                   | 220V/50Hz      | 220V/50Hz  | AC 220V/50Hz |
| Liquid PH                 | 6.5 ~ 8.5      | 6.5 ~ 8.5  | 6.5 ~ 8.5    |
| Maximum particle size     | 0.1mm          | 0.1mm      | 0.1mm        |
| Medium temperature        | 0°C ~ 50°C     | 0°C ~ 50°C | 0°C ~ 90°C   |
| Ambient temperature       | 0°C ~ 55°C     | 0°C ~ 55°C | 0°C ~ 40°C   |
| Voltage fluctuation range | ±10%           | ±10%       | ±10%         |

## Performance curve

Model: PFM03-30EC Pro / PFM03-30EC

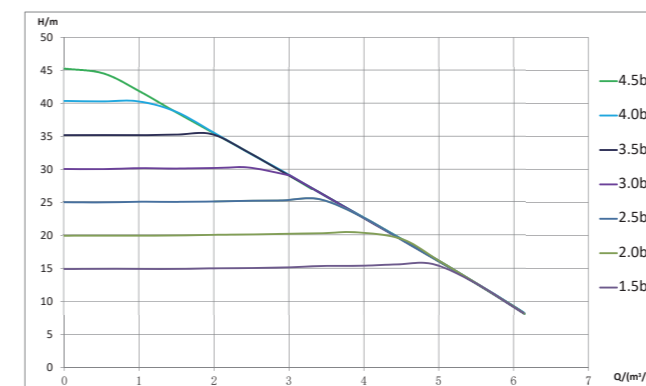

# Constant home booster

Permanent magnet centrifugal pump



Model: PFB06-22EC

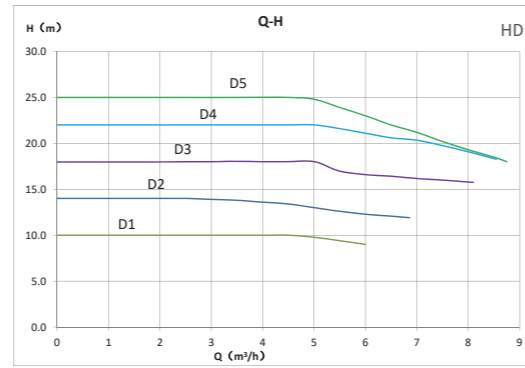
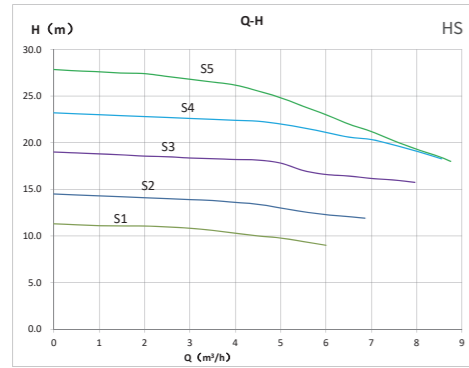

Installation dimensions

Model: PFM03-30EC/ PFM03-30EC Pro

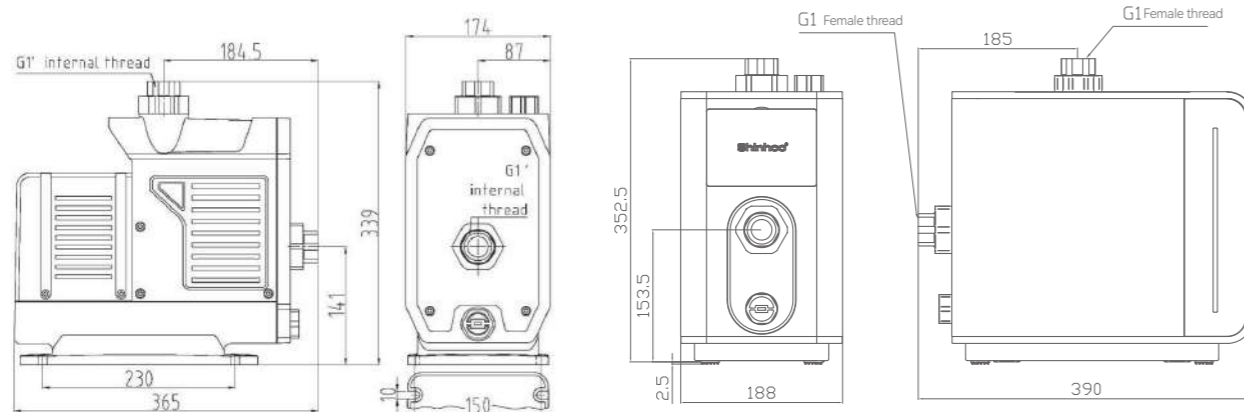

Model: PFB06-22EC

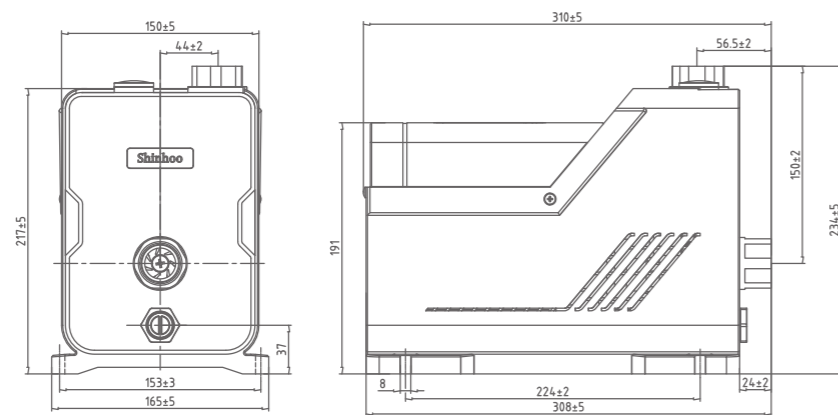

Performance curve



PFM03-30EC Pro



PFM03-30EC



PFB06-22EC

Technical Data

| Model          | Max Flow (m³/h) | Max Head (m) | Rated Flow (m³/h) | Rated Head (m) | Max Power (W) | Rated Voltage (V) | Max RPM (r/min) | Inlet And Outlet Size (internal thread) |
|----------------|-----------------|--------------|-------------------|----------------|---------------|-------------------|-----------------|---|
| PFM03-30EC Pro | 5.5             | 45           | 3                 | 30             | 600           | 220               | 5000            | G1"                                     |
| PFM03-30EC     | 5.5             | 45           | 3                 | 30             | 600           | 220               | 5000            | G1"                                     |
| PFB06-22EC     | 8.5             | 28           | 6                 | 22             | 700           | 220               | 5000            | G1"                                     |

# Structural Diagram

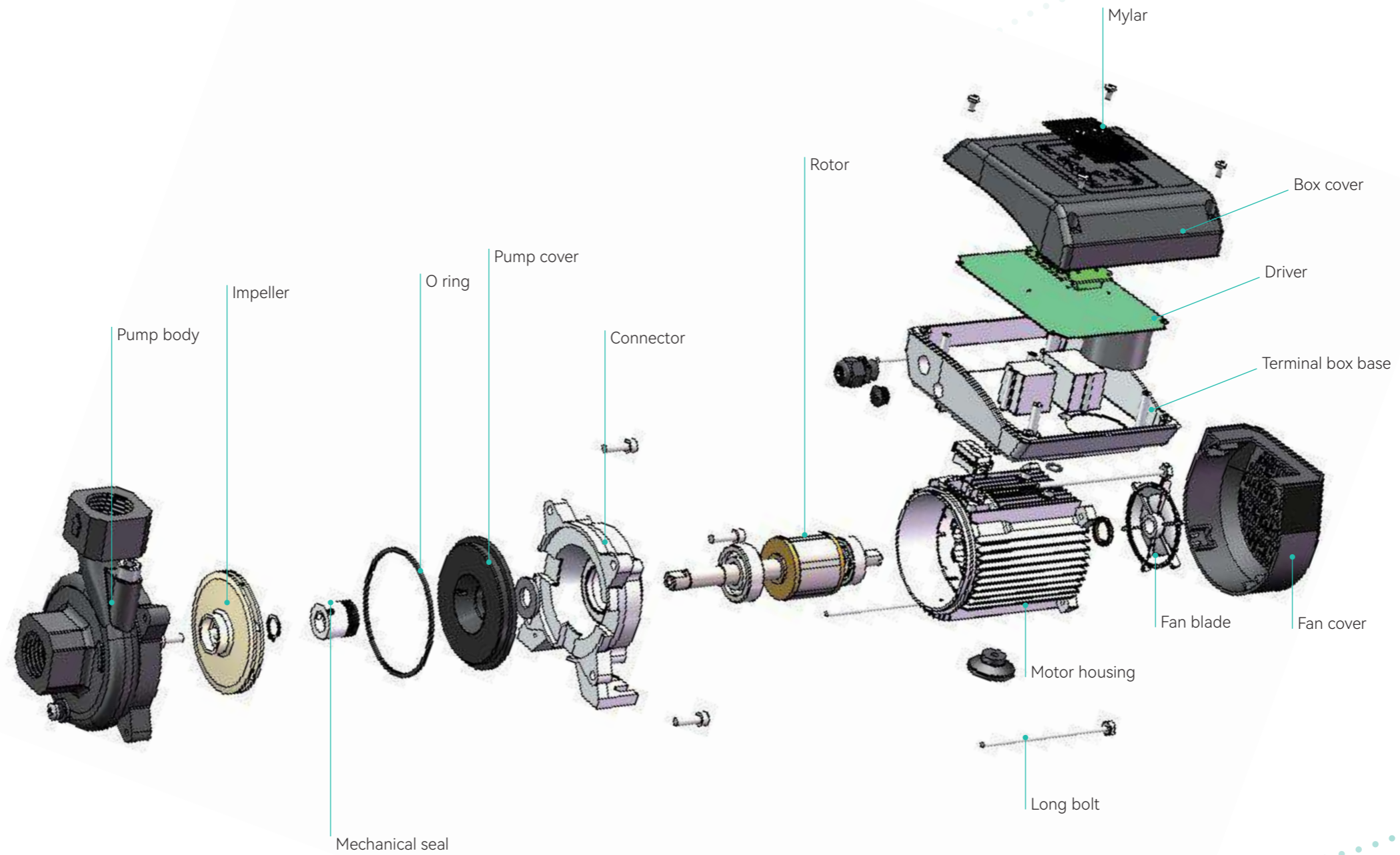



## Application

- Air source heat pump system
- Solar heating system
- Domestic hot water system, etc



## Operation Condition

| Model                     | PFB06-22 Pro     | PFM08-36            |
|---------------------------|------------------|---------------------|
| Voltage                   | AC 220~240V/50Hz | AC 220~240V,50/60Hz |
| Liquid PH                 | 6.5 ~ 8.5        | 6.5 ~ 8.5           |
| Maximum particle size     | 0.1mm            | 0.1mm               |
| Medium temperature        | 0°C ~ 90°C       | -20 °C~9 0°C        |
| Ambient temperature       | 0°C ~ 40°C       | -20 °C ~ 55 °C      |
| Voltage fluctuation range | ±10%             | ±10%                |



# Booster

Permanent magnet centrifugal pump

## Performance curve

Model:PFB06-22 Pro

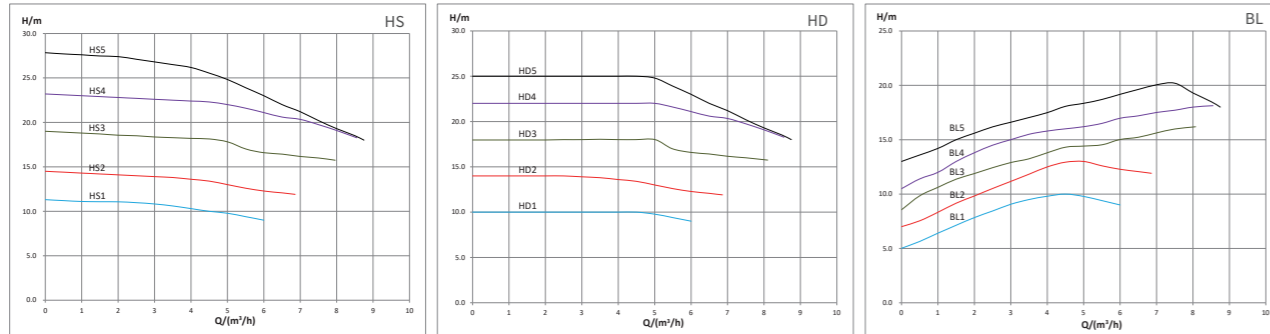

Model:PFM08-36

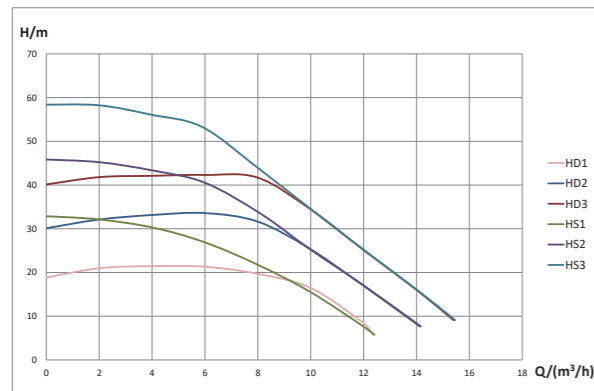

## Installation dimensions

Model:PFB 06-22 Pro

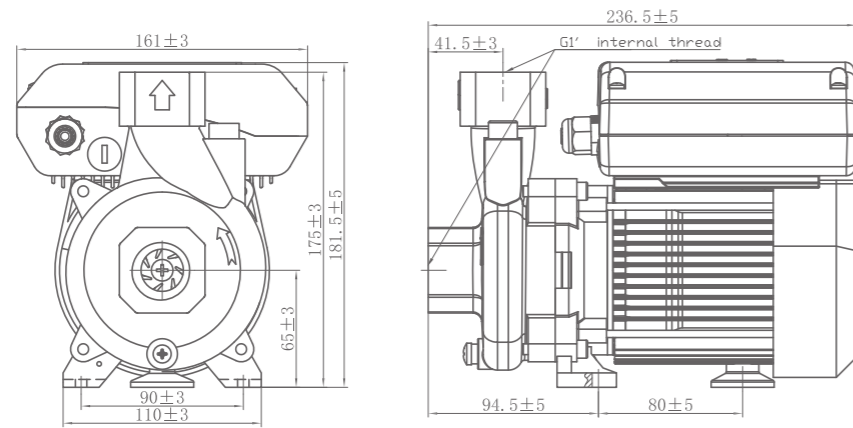

Model:PFM08-36

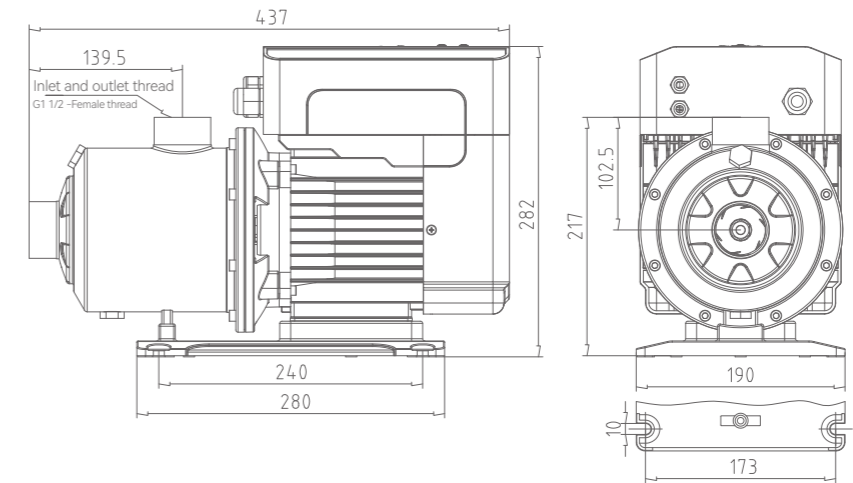

## Performance curve



PFB06-22 Pro



PFM08-36

## Technical Data

| Model        | Max Flow (m³/h) | Max Head (m) | Rated Flow (m³/h) | Rated Head (m) | Max Power (W) | Rated Voltage (V) | Max RPM (r/min) | Inlet And Outlet Size (internal thread) |
|--------------|-----------------|--------------|-------------------|----------------|---------------|-------------------|-----------------|---|
| PFB06-22 Pro | 8.5             | 28           | 6                 | 22             | 700           | 220-240           | 5000            | G1"                                     |
| PFM08-36     | 15              | 58           | 8                 | 36             | 1800          | 220-240           | 3500            | G1 1/2"                                 |

# Structural Diagram

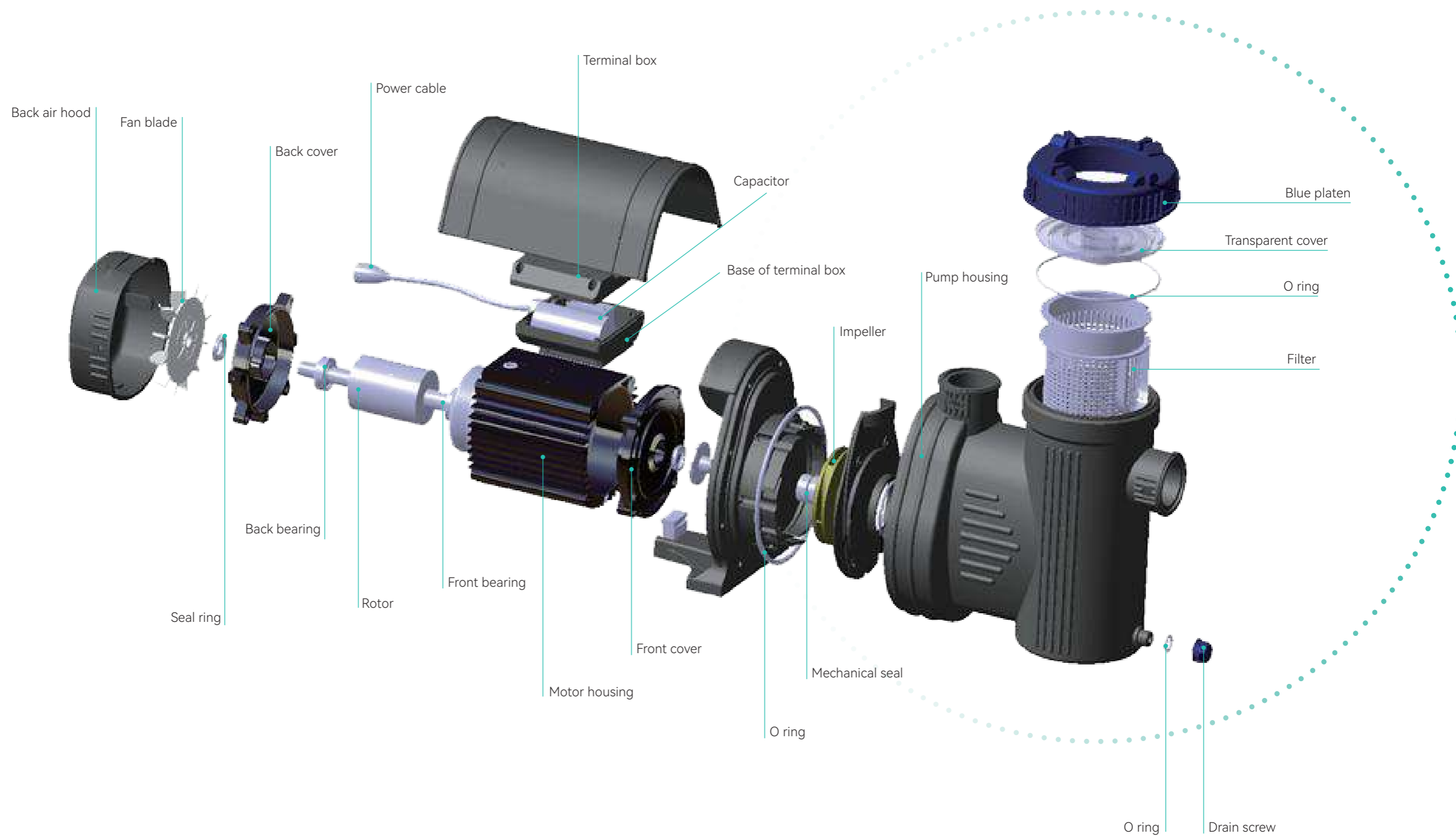

## Swimming pool pumps



### Application:

Small family swimming pool  
Family Garden Supply  
Sea water beauty cultivation



## Application

- Small family swimming pool
- Family Garden Supply
- Sea water beauty cultivation



## Technical Data



# SP Series

## Swimming pool pumps

| Performance parameter |   |         |         |         |             |          |             |
|-----------------------|---|---------|---------|---------|-------------|----------|-------------|
| Model                 | SP-370A                                       | SP-450A | SP-550A | SP-750A | SP-7000A    | SP-8000A | SP-4001     |
| Electrical connection |   |         |         |         |             |          |             |
| Voltage               | 1-220V/50Hz                                   |         |         |         |             |          |             |
| Input power(W)        | 400   | 500     | 600     | 850     | 450         | 500      | 300         |
| HP                    | 0.5   | 0.7     | 0.8     | 1.2     | 0.6         | 0.7      | 0.4         |
| Application           |   |         |         |         |             |          |             |
| Medium                | Clean water                                   |         |         |         |             |          |             |
| Medium temp.          | 5°C~50°C                                      |         |         |         |             |          |             |
| Max. Head(m)          | 8.5   | 8.5     | 10.5    | 13      | 9.3         | 10.5     | 7.5         |
| Max. Flow(m³/h)       | 8   | 10.5    | 12      | 14.5    | 12          | 12       | 7.5         |
| Self-priming(m)       | 2.5   | 2.5     | 2.5     | 2.5     | 2.5         | 2.5      | 2.5         |
| Inlet Dia.(mm)        | 40  | 40      | 40      | 40      | 40          | 40       | 40          |
| Outlet Dia.(mm)       | 40  | 40      | 40      | 40      | 40          | 40       | 40          |
| Max. Pressure(bar)    | 3.5   | 3.5     | 3.5     | 3.5     | 3           | 3        | 3           |
| Protection Level      | IP55  | IP55    | IP55    | IP55    | IP55        | IP55     | IP55        |
| Weight(kg)            | 9   | 10.5    | 13.9    | 15.9    | 6           | 6        | 5           |
| Carton size(mm)       | 535*225*345                                   |         |         |         | 430*210*235 |          | 310*190*240 |
| Material              |   |         |         |         |             |          |             |
| Pump Housing          | Engineering plastic                           |         |         |         |             |          |             |
| Impeller              | Engineering plastic                           |         |         |         |             |          |             |
| Shaft                 | SUS304+45#/20Cr13                             |         |         |         |             |          |             |
| Mechanical Seal       | Graphite & Ceramic/Graphite & Silicon Carbide |         |         |         |             |          |             |

## Performance curve

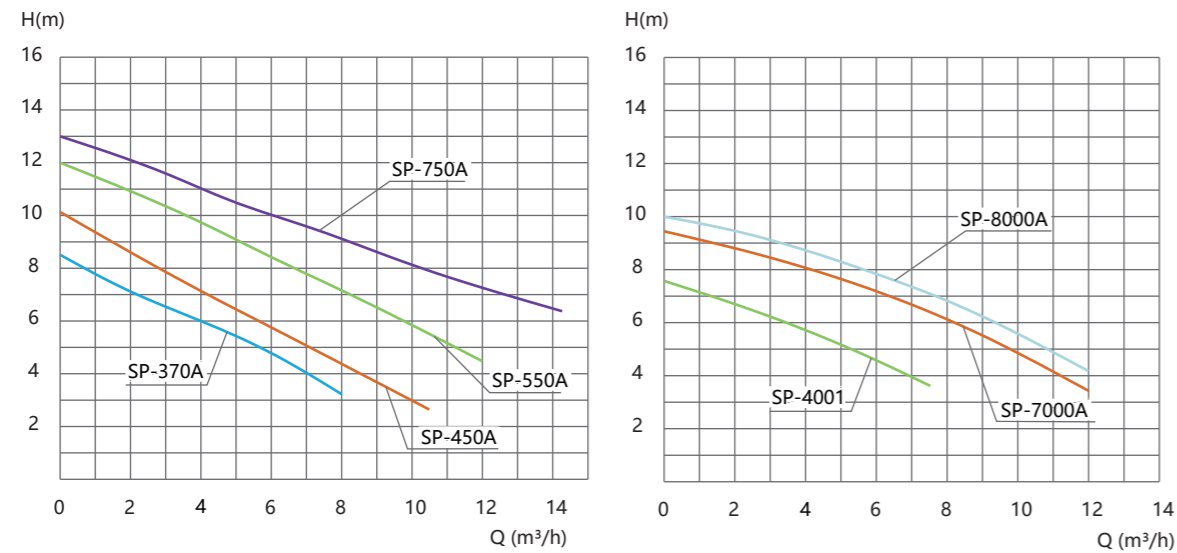

## Installation dimensions

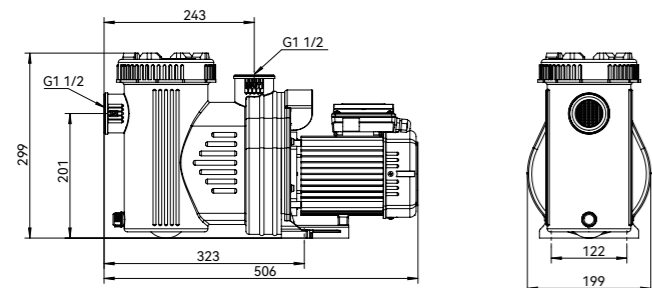

SP-370A, 450A, 550A, 750A

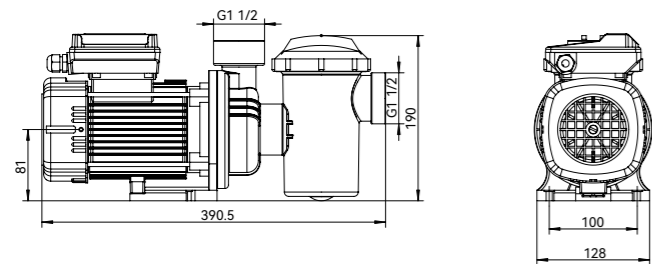

SP-4001

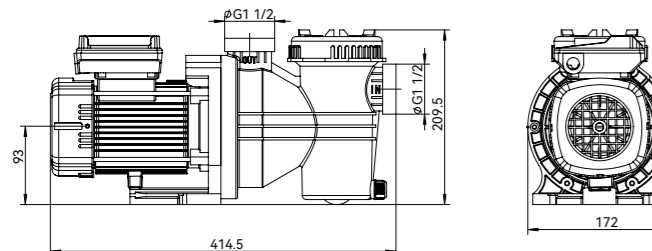

SP-7000A, 8000A



**F-SP Pro Series**  
Swimming pool pumps  
with frequency converter

## Application

- It is used for water circulation in all kinds of small domestic swimming pools .
- Slightly dirty water with solids in suspension can be perfectly filtered .

## Performance curve

Model:F-SP 16000 Pro

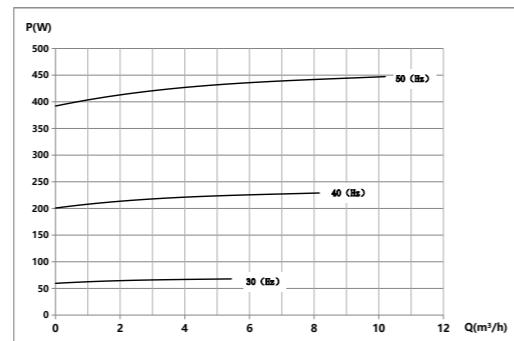
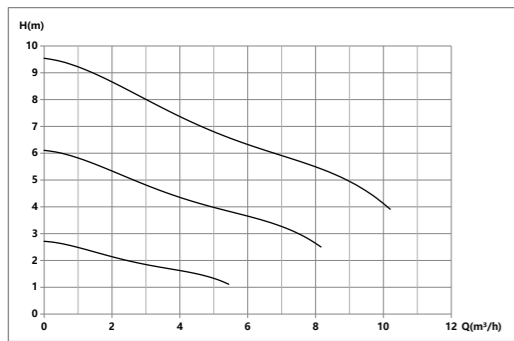

Model:F-SP 19000 Pro

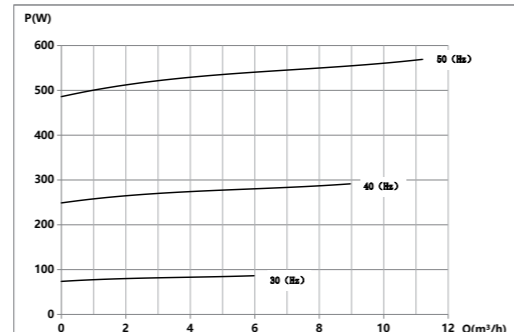

Model:F-SP 21000 Pro

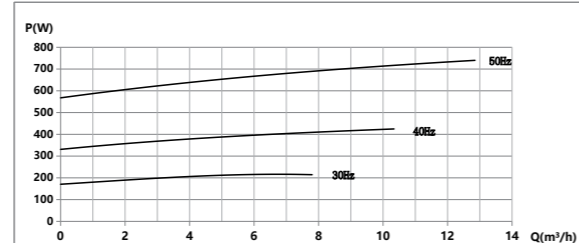
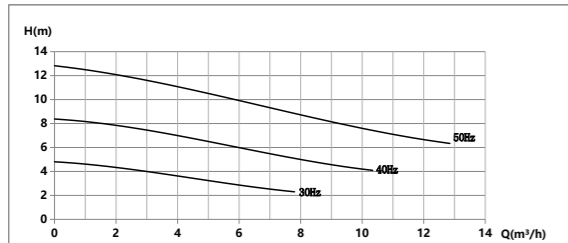

## Features

- Dual Operation Modes
  - Regulate by Hz: 0-50Hz
  - Regulate by RPM: Three gears
- User Friendly Display
- Energy saving up to 75%

## Technical Data

| Model          | Max Flow (m <sup>3</sup> /h) | Max Head (m) | Max Suction (m) | Input Power (W) | Rated Power (W) | Rated Voltage (V) | Rated RPM (r/min) | IP Class |
|----------------|------------------------------|--------------|-----------------|-----------------|-----------------|-------------------|-------------------|----------|
| F-SP 16000 Pro | 10                           | 8.5          | 2.5             | 500             | 340             | 220~240           | 2860              | 55       |
| F-SP 19000 Pro | 11.5                         | 10.5         | 2.5             | 600             | 400             | 220~240           | 2860              | 55       |
| F-SP 21000 Pro | 13                           | 13           | 2.5             | 850             | 600             | 220~240           | 2860              | 55       |